

Transfer or duplication of this document as well as the utilisation or communication of its content are not permitted unless express consent is granted. Violations give rise to claims for damages. All rights reserved in case of patent, utility model or design patent registrations.

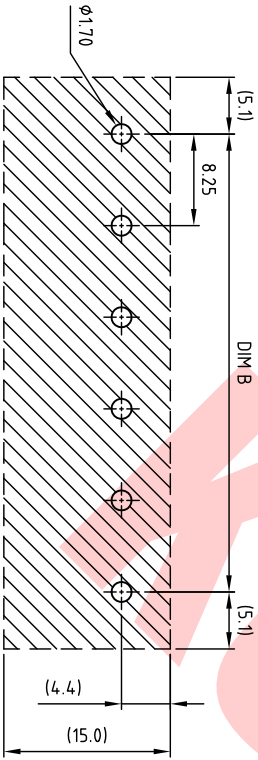
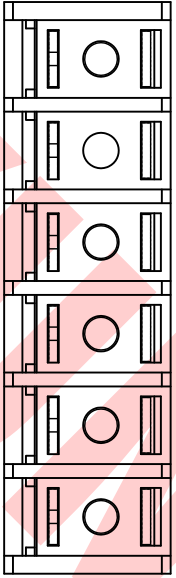
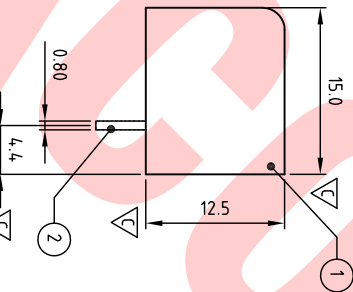
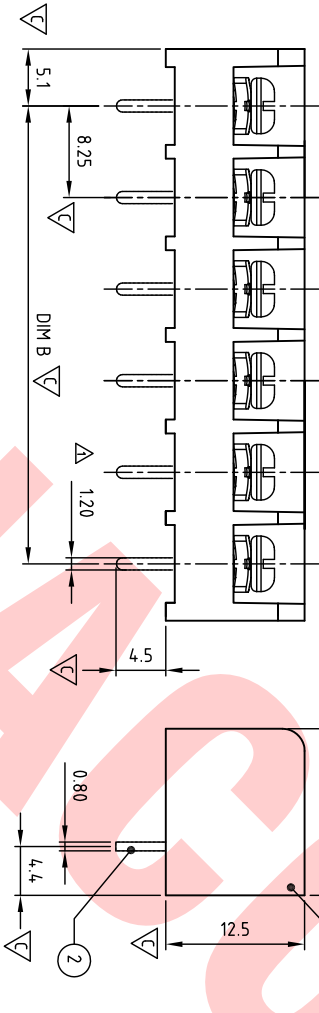
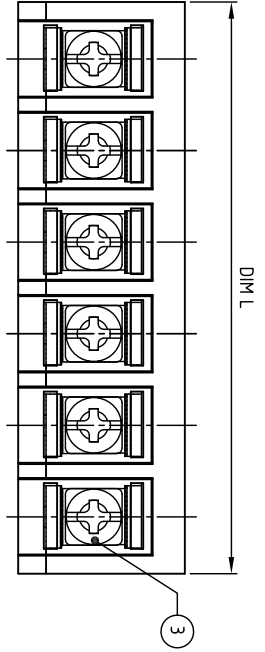

PCB Layout

Technical data

1.Nominal voltage: 300V/20A
PITCH: 8.25mm

2.Connection capacity:
AWG 22-12

3. Insulation Withstands Voltage:
AC 2500V/MIN

4. Insulation Resistance:
1000M Ω or more at DC500V

5. Tightening torque:
10.15kgf.cm (8.8 Lb-In / 1.0N.m)

6. Screw thread: M3
7. Using temperature range: -40C \sim -115C \circ
Soldering temperature: 250 \pm 10C \circ /5s

8. Undimensioned Tolerances:

	Dim L = P x 8.25 + 1.95	Dim B = (P - 1) x 8.25	P = number of poles
0-30mm	± 0.15	± 0.20	
over 30mm-60mm	± 0.20	± 0.30	
over 60mm-90mm	± 0.25	± 0.40	
over 90mm-180mm	± 0.30	± 0.50	
over 180mm	± 0.50	± 0.80	

9. Safety approval:
10. RoHS Compliance
11. Critical dimension:

ZDA A825 xx x xxx

- ① Poles 02-20
- ② Color
- ③ 0 Black
- ④ Custom
- 000 "K" logo 00K KUNACON logo

ITEM	NAME OF PART	MATERIAL	NOTES	QTY
3	SCREW+WASHER	STEEL	M3x0.5, Ni Plated	P
2	CONTACT	BRASS	M3x0.5, Tin PLATED	P
1	BODY	PA66 UL94V-0	Black	1

DWG.	WF. Zhang	DATE	2016.08.10	UNITS:	MM	SHEET:	1 OF 1	Tolerance
CHK.	WF. Zhang	DATE	2017.07.10	SCALE:	NONE 2:1 (.)	REV.:	B	± 0.50
APP.	WF. Zhang	DATE	2017.07.10	TITLE:	ZD-AA825 Series			± 0.30
					Barrier Terminal block			± 0.10
					ZDAA825xxxxxx			$\pm 1^{\circ}$

PART NO.	ZDAA825xxxxxx
DWG NO.	ZD-AA825-B001

SIGN	DESCRIPTION	CHK.	DATE
	尺寸变更 11-->12mm.	WF. Zhang	10/10/16

KUNA Contact Technology Co. Ltd
http://www.kunacon.com